

RS485 network single door access control keypad



EB-83's MAIN PARAMETER

Parameter

| | |
|-----------------------------|---|
| Name | RS485 network single door access control keypad |
| Model | EA-83 |
| Working voltage | DC12V±DC3V |
| Working power | <2W |
| Type of Card | Mifare IC 13.56Mhz |
| Induction distance | Max 90mm |
| Capacity of records | 10000 |
| Capacity of users | 10000 |
| Waterproof | IP66 |
| Communication format | RS485 |
| Transmit rate | 9600bps(N,8,1) |
| Data storage | 4M bits FLASH Memory |
| Dimensions | 96L×96W×22H(mm) |
| Color | Black/White(optiona) |
| Material | ABS+PCB board |
| Environment temp | -30°C to +60°C |
| Open mode | Card |
| Weight | 260g |

1. Appearance of special design, with beautiful energy-saving background light, and more fashionable.

2. Use imported PC materials, impact-resistant, heat-resistant, corrosion-oriented.
3. Use the advanced flash memory storage technology. Even if the power is off, the access log can be stored for 10 years.
4. With the Laser carving technology, the numbers of the keypad are wear-resistant. After a long time use the number isn't fallen.
5. With 100 sets of time zone regulations, control when and how to open the door. Set on the device directly when use it as a standalone.
6. Register the user cards via the manager card on the keypad (used as standalone), and also via the software.
7. With anti-stress functions input reverse personal passwords and open the door, immediately the alarm output signals is transmitted to the alarm center.
8. A variety of passwords, flexible use. Super passwords isn't limited from access system; personal passwords can be set up directly on the keypad.
9. High safety performance, with tamper function.
10. Free green software, with basic and simple functions, easy to operate.
11. With a reverse current protection, lightning protection, anti-crash design, self-detection.

Appearance



Wiring diagram

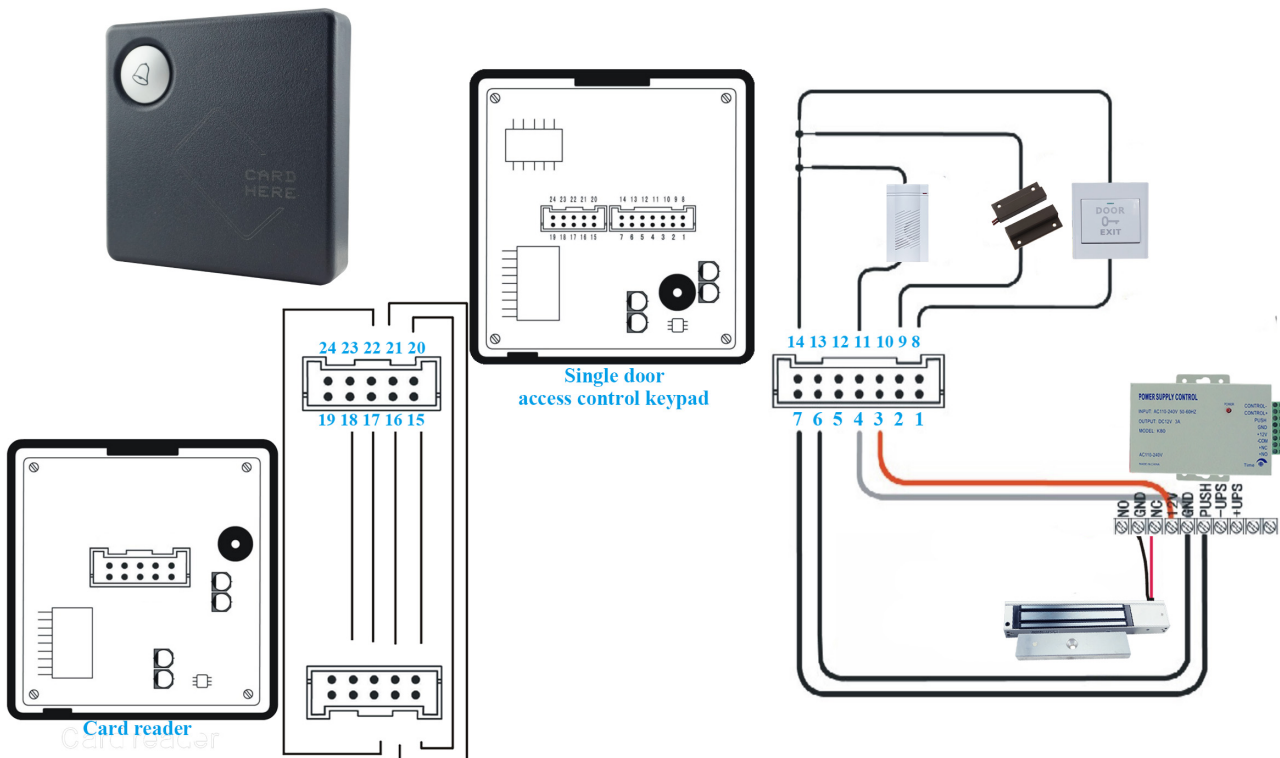

| Wire port specification | | |
|-------------------------|----------------|--|
| NO | Function | Description |
| 1 | RS485+ | Data + |
| 2 | RS485- | Data - |
| 3 | 12V+ | DC Power 12V |
| 4 | GND | GND |
| 5 | OUT-NC | Door relay NC interface |
| 6 | OUT-COM. | Door relay COM interface |
| 7 | OUT-NO. | Door relay NO interface |
| 8* | IN 1 | Input 1, door release button input |
| 9* | IN 2 | Input 2, door magnet signal input |
| 10* | IN 3 | Input 3, user-defined |
| 11 | OC OUT | Build-in doorbell signal output |
| 12* | OUT 2 | OC signal, duress output |
| 13* | OUT 3 | OC signal, anti-tamper output |
| 14 | GND | GND |
| 15 | OUT 12V+ | Power output, can be connected to WG reader power + |
| 16 | GND | Power output, can be connected to WG reader power GND |
| 17 | DATA 0 | WG Data 0 input, connect reader Data 0 |
| 18 | DATA 1 | WG Data 1 input, connect reader Data 1 |
| 19 | GND | GND |
| 20 | OC1-OUT | Unregistered card output, OC signal output for 3s after card flashing to open the door, can connect Green LED end of WG reader. |
| 21 | OC2-OUT | Unregistered card output, OC signal output for 3s after card flashing but not to open the door, can connect Red LED end of WG reader. |
| 22 | OC3-OUT | Unregistered card output, OC signal output for 3 times after card flashing to open the door, each interval time is 100ms, can connect Beeper end of WG reader. |
| 23 | NULL | N/A |
| 24 | ANTI-TAMPER-IN | Anti-tamper signal input, connect anti-tamper output signal of WG reader |

Installation

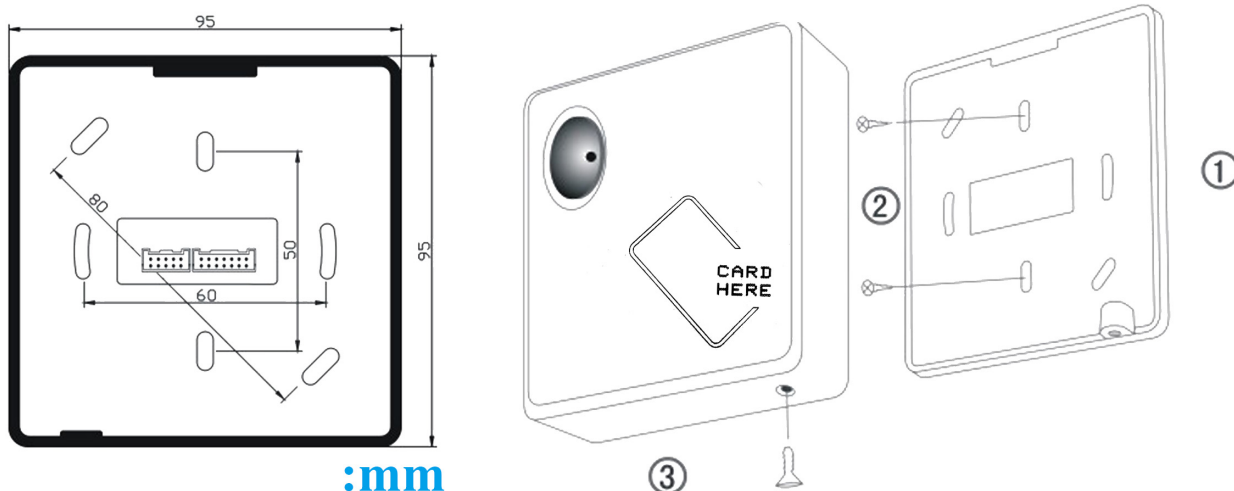

HOW ABOUT OTHER CHOICE?

SMQT[®]
铭汗科技



SMQT[®]
铭汗科技



SMQT[®]
铭汗科技



SMQT[®]
铭汗科技



SMQT[®]
铭汗科技



SMQT[®]
铭汗科技



SMQT[®]
铭汗科技



SMQT[®]
铭汗科技



SMQT[®]
铭汗科技

