

New

Access control & Alarm product supplier



Specification

Name	LCD Biometric face&fingerprint&password access controller keypad
Power supply	DC12V
Current	<350mA
Dimension	160mm*92mm*30mm
Weight	0.28kg
Working temperature	-20°C~50°C
Working humidity	10%~85%
Storage capacity	100000 record capacity, 500 pcs face,1500 pcs fingerprint, 500 pcs password
Recognition speed	□0.5s
FRR	<0.01%
FAR	<0.001%
Communication way	U disk, RS485,TCP/IP
WG signal	WG26/WG34 adjustable
Keyboard configuration	Ten number keys and six function keys
Menu language	10 languages adjustable(Chinese, tradition Chinese, Spanish,Korean, Japanese, Vietnamese, Turkish, Indonesian, Thai)



Device introduction

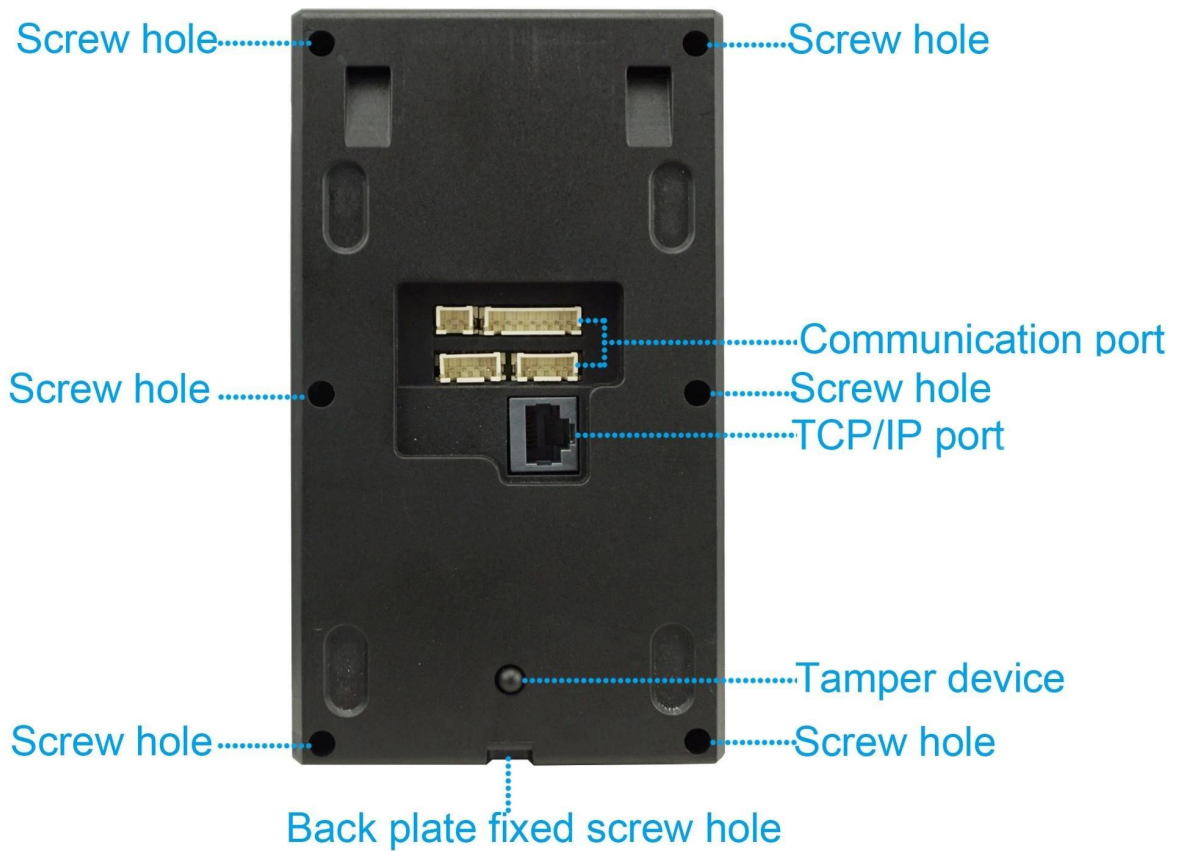
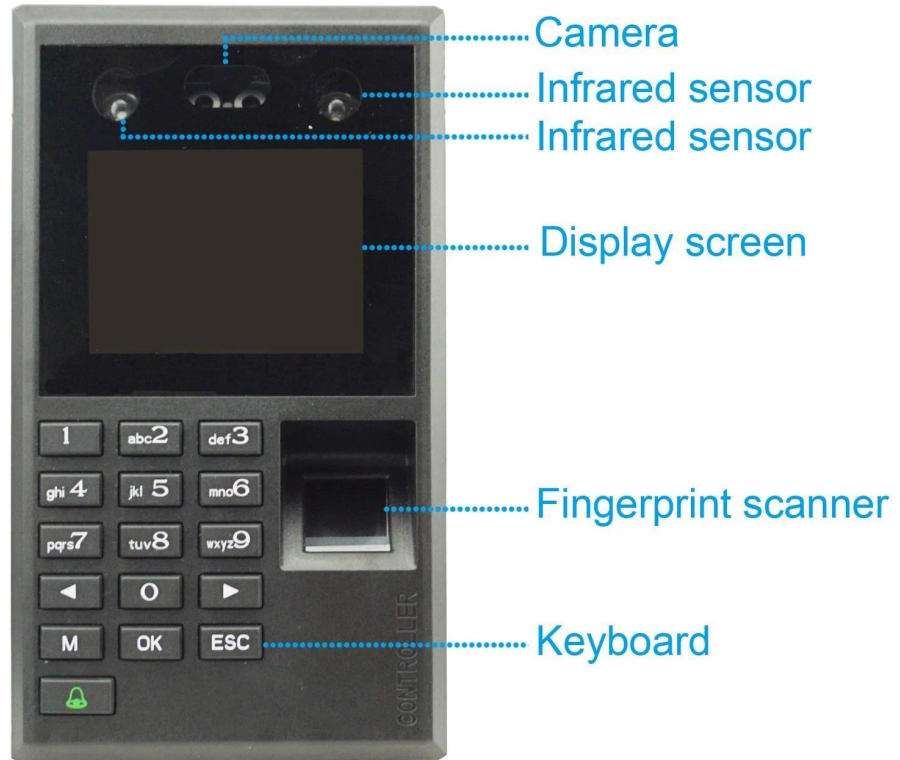



Back plate fixed hole

Back plate fixed hole

Back plate fixed screw hole



U disk port

Reset hole

Back plate fixed screw hole

Packaging



OUR TEAM



RELATED PRODUCT

SMQT
铭汗科技



SMQT
铭汗科技



SMQT
铭汗科技



SMQT
铭汗科技



SMQT
铭汗科技



SMQT
铭汗科技



SMQT
铭汗科技



SMQT
铭汗科技



SMQT
铭汗科技

