

# WIFI App control cordless GSM wireless home alarm system kit

## Product Description

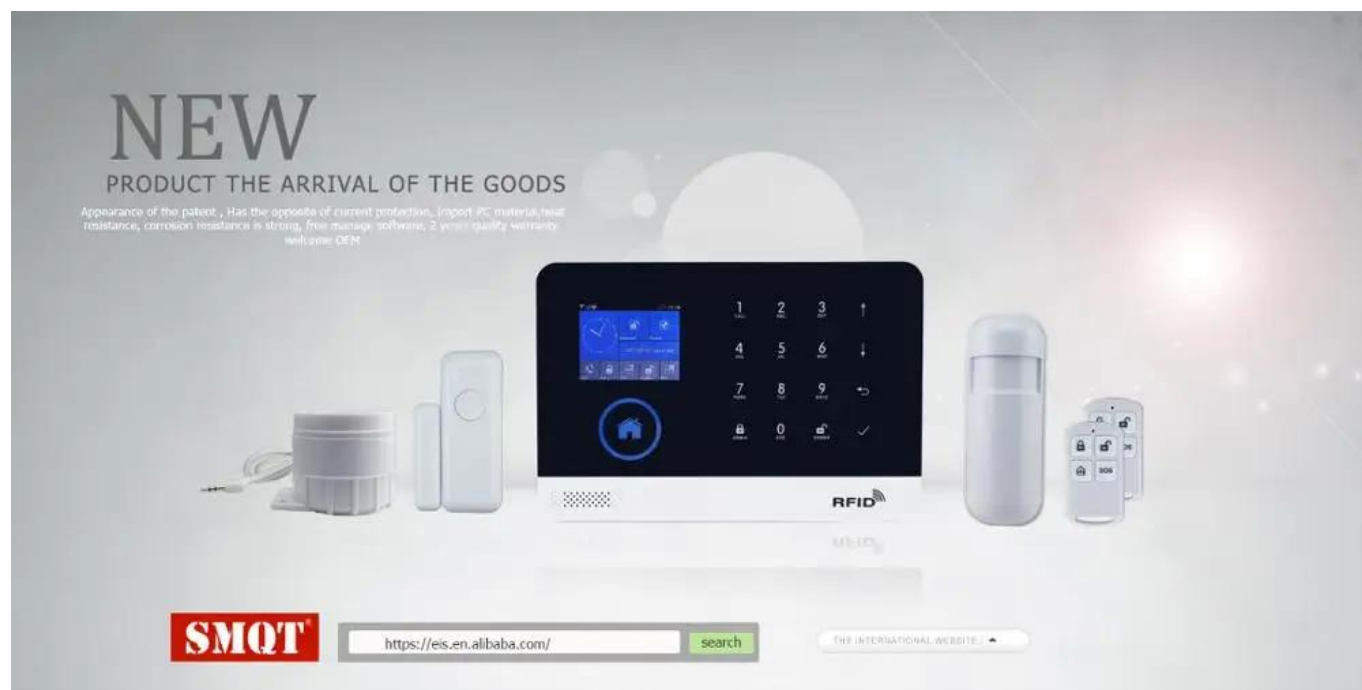

Specification	
Product name	LCD display WIFI+GSM+App control alarm kit for home alarm system
Model	EB-821
box case dimension	210*150*75(mm)
Keypad dimension	185×125×14.7mm(L×H×T)
Power supply	110V~220V AC or DC 5V(micro USB jack)
Static current	≤80uA
Alarm current	≤120mA
Siren output	<500mA
Defence zone	Max 100 pcs wireless accessories
GSM Band	4-band (850/900/1800/1900Mhz)
WIFI format	IEEE802.11b/g/n
Working temperature	0°C~+55°C
Working humidty	<80%
System Wireless Frequency	433Mhz(1527 code,330K)
Backup battery	3.7V/500Ah Lithium battery
Cellphone App	Andorid & IOS App
Weight	0.7kg

**Product Feature**

---







## Dual Mode Supported



### All Advantage of Traditional GSM System :



Message or call sending to phone when alarm alerts.



Two-way talking supported as phone calling mode.



Monitor the home if alarm call holding.



Call the saved phone in orders if missing the alarm call, voice message playing in the mean time.



Schedule the working mode and it will work automatically in time as you set.



### Beside, What a WIFI System Can Do :



Phone notification even no SIM card or GSM service.



Arm/ disarm the system remotely when friends coming.



A quick view in the same app if you have a DigooEye camera.



Easily finish all the setting and view all status from app.



Phone receive SOS request from the remote controller's user in emergency.

## Full accessories to meet your need



### Wireless 433MHZ Pir Detector

The original Red-dot award design PIR sensor, 120° wide detection angle, up to 12 meters detection distance, easy to install and adjustable, highly sensitive and anti HF interference, with temperature compensation avoid false alarm



### Wireless 433MHZ Door Sensor

Pair of magnetic sensor, ultra thin and sensitive, trigger an alarm once the "gate" open. Not only suit for place at doors or windows, but also can put drawers or your personal box. It has a great demand and widely use in smart home alarm system



### Wireless 433MHZ Remote Control

One button to armed/disarmed the system, strong RF transmission, allows you control the system in your palm from long distance, one click to alarm for emergency situation. works as a keychain near you.

## Double Protection Special Design Against Disassembling

It has a special design at the back that other people can't disassemble it easily.  
Once bad guys try to open the system, the siren will louds.







## More Friendly User Experience



Stay armed active/ Out armed active



Search the record of alarm alert  
and arm/disarm record



Added max to 99 defence zone.



Delay alert time setting



Language setting

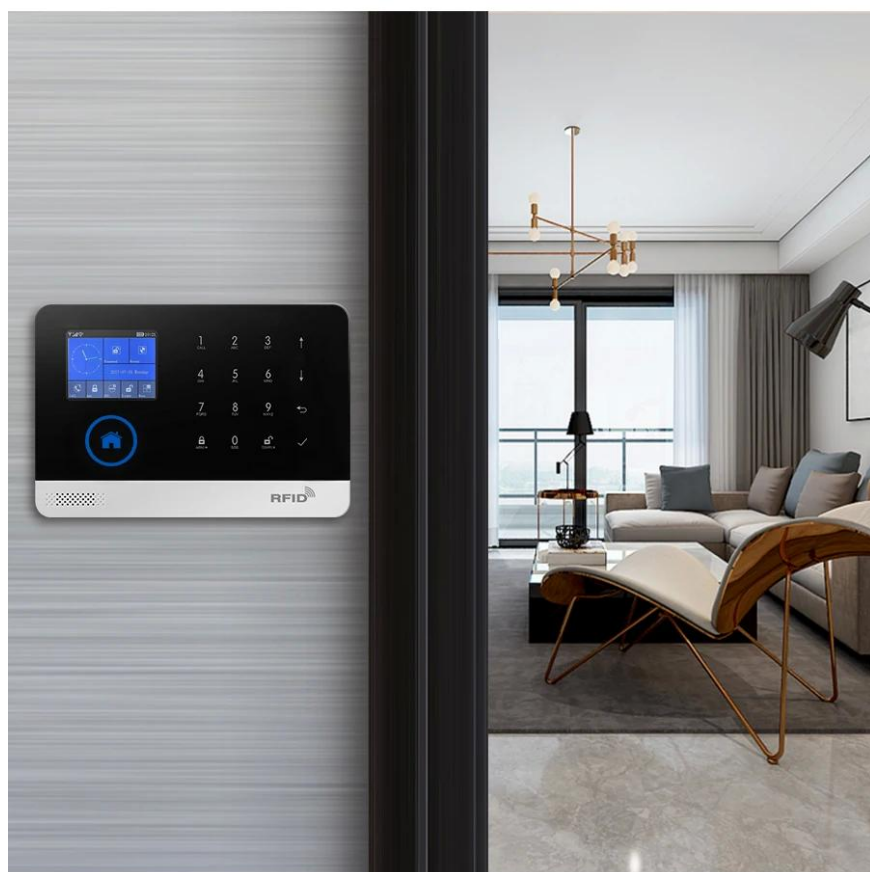



**1.2.4 inch TFT display screen, concise user interface and menu hint design.**

**2.Main interface status bar,date/clock indication, fairly obvious alarm host statues.**

**3.Built-in powerful performance CPU master based on 32-bit Cortex-M3 core.**

**4.Based on Ucos-III operating system with multitasking design, great user operation experience.**

**5.WIFI/GSM/3G/GPRS intranet alarm system,support different alarm channels, like APP push/SMS/voice monitoring/intranet center etc. to ensure the alarm performance stable and reliable.**

**6.Support SMS arm/disarm and voice arm/disarm.**

**7.Support up to 100 learning/storage location for remote controls, RFID cards and wireless detectors.**

**8.Support many defense zones,such as gate,SOS,bedroom>window, balcony, perimeter, smoke, gas, carbon monoxide,water leaking,etc.**

<b>9.Support the main power malfunction, backup power shortage,tamper alarm and other extended alarm.</b>
<b>10.Support entry/exit zone, inddor zone, perimeter zone, 24-hour zone..etc.</b>
<b>11.Up to 5 groups preset alarm phone numbers, SMS on/off and dial on/off can be set respectively.</b>
<b>12.Support external wireless siren,timing arm and disarm.</b>
<b>13.Can store and inquire daily operation records and alarm records</b>
<b>14.GSM network clock synchronization, to ensrue accurate clock, and support country time zone setting.</b>
<b>15.Support multi-language menu display, voice prompts and alarm SMS setting.</b>
<b>16.Can record 20 seconds voice message and alarm voice.</b>
<b>17.Telephone function,support 5 groups re-dial number.</b>
<b>18.User-friendly APP operation experience and user interface, the host will send Arm/Disarm message to App</b>
<b>19.Support App Remote Arm/Disarm, parameter setting and accessory management.</b>
<b>20.Online GPRS to obtain equipment status, automatic alarm when offline.</b>
<b>21.Reserved remote GPRS TCP/UDP protocol channel, compatible with multiple alarm center networking protocol to facilitate network alarm.</b>

#### **Product Display**

---

## **IN-KIND SHOOTING**





INSTRUCTIONS FOR USE









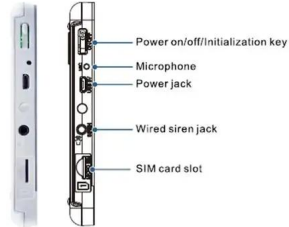
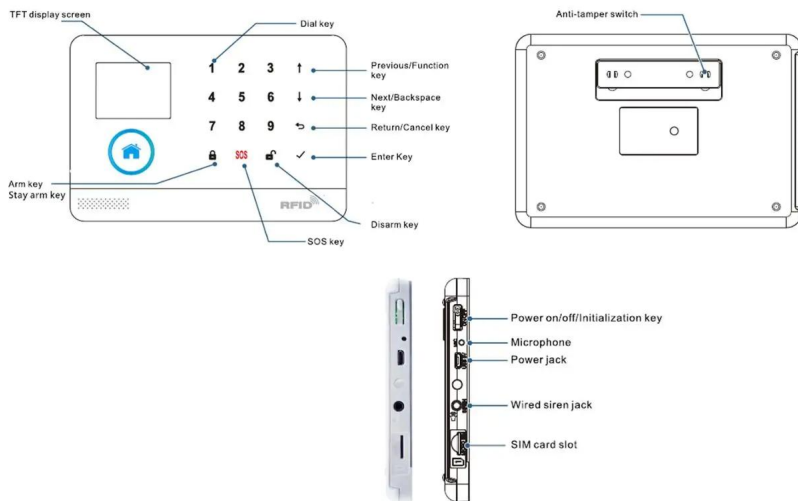

**Wireless 433Mhz communication**  
(EV 1527 coding, 330k)



**Wireless transmitting distance 15~20m**



**Cell phone App control:**



**Free Android & IOS cell phone App**



**Scan the top two-dimensional code to download phone App**



## Show Cases

## RELATED ITEMS SHOWCASES

SMQT® 深圳市铭汗科技有限公司  
SHENZHEN MINGQIAN TECHNOLOGY CO.,LTD



FC CE <https://eis.en.alibaba.com>

SMQT® 深圳市铭汗科技有限公司  
SHENZHEN MINGQIAN TECHNOLOGY CO.,LTD



FC CE <https://eis.en.alibaba.com>

SMQT® 深圳市铭汗科技有限公司  
SHENZHEN MINGQIAN TECHNOLOGY CO.,LTD



FC CE <https://eis.en.alibaba.com>

SMQT® 深圳市铭汗科技有限公司  
SHENZHEN MINGQIAN TECHNOLOGY CO.,LTD



FC CE <https://eis.en.alibaba.com>

SMQT® 深圳市铭汗科技有限公司  
SHENZHEN MINGQIAN TECHNOLOGY CO.,LTD



FC CE <https://eis.en.alibaba.com>

SMQT® 深圳市铭汗科技有限公司  
SHENZHEN MINGQIAN TECHNOLOGY CO.,LTD



FC CE <https://eis.en.alibaba.com>

SMQT® 深圳市铭汗科技有限公司  
SHENZHEN MINGQIAN TECHNOLOGY CO.,LTD



FC CE <https://eis.en.alibaba.com>

SMQT® 深圳市铭汗科技有限公司  
SHENZHEN MINGQIAN TECHNOLOGY CO.,LTD



FC CE <https://eis.en.alibaba.com>

SMQT® 深圳市铭汗科技有限公司  
SHENZHEN MINGQIAN TECHNOLOGY CO.,LTD



FC CE <https://eis.en.alibaba.com>

## Company Information

## OFFICE SHOW





## CUSTOMERS



## EXHIBITION

2011 Brazil Fair



2012 shen yang Fair



2013 Jinan Fair



2013 Shenzhen Fair



2012 shen yang Fair



2013 shen yang Fair



2013 Shenzhen Fair



2015 Shenzhen Fair



## CERTIFICATION



## Our Services

## HOW TO COOPERATE

## PACKAGING AND SHIPPING



Express Delivery.....!



## FAQ

## FAQ

**Q:Can I have a sample order?**

**A:Yes, we are willing to offer trial sample order to you for quality test. Mixed samples are acceptable.**

**Q:What is the lead time?**

**A:Sample needs 1-3 working days, mass production time needs 10-15**

**working days.**

**Q:What is your MOQ?**

**A:No MOQ limit.The more quantity the more discounts.**

**Q:How do you ship the goods and how long does it take arrive?**

**A:The sample will be sent to you by optional shipping service (couriers, air, and sea),or appointed by buyer,7-15 days.**

**Q:How will we proceed the order if I have logo to print?**

**A:Firstly, we will prepare artwork for visual confirmation. If the color and position are right, we would make sampling firstly from silk print factory and take picture for your second confirmation before mass production.**

***How to contact us?  
Click the enter send us inquiry below.***