

SMQT Alloy door access control exit release push button NC NO COM port with LED back light

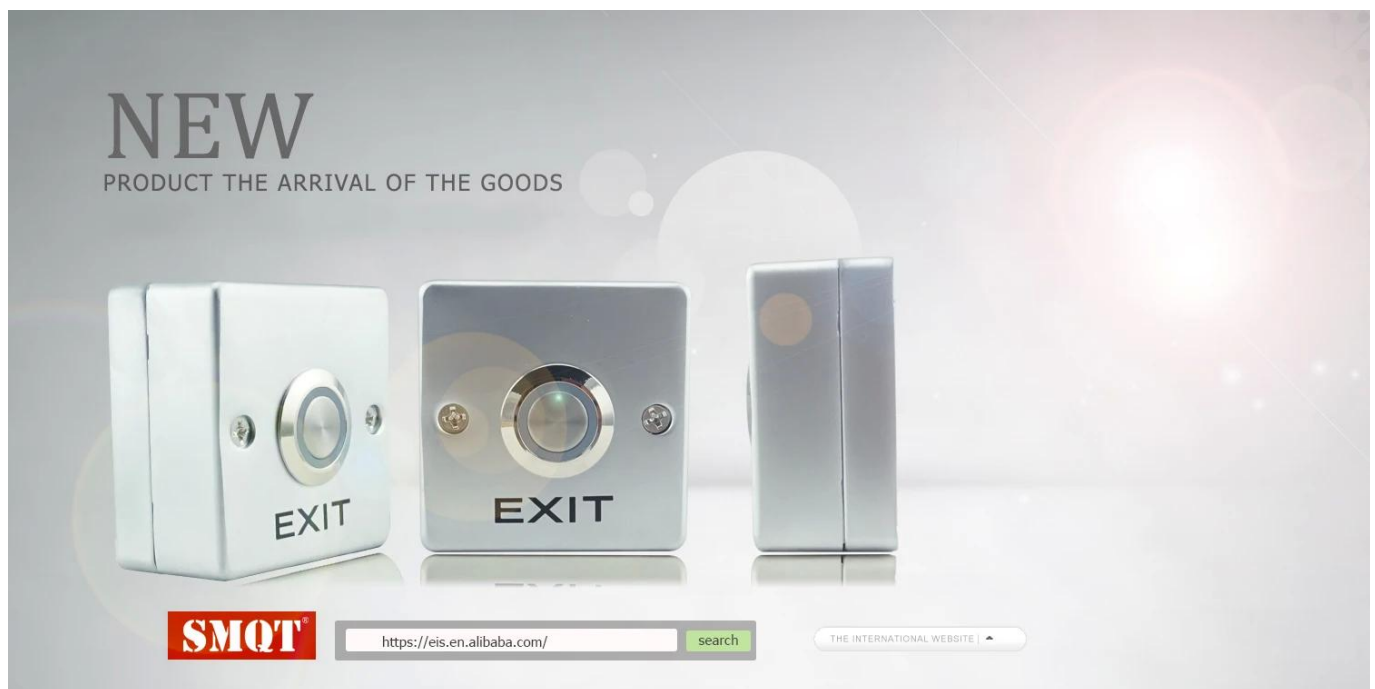

Product Name:	SMQT Alloy door access control exit release push button NC NO COM port with LED back light
Model:	EA-23D
Size:	50mm*50mm*24mm
Working voltage:	Max 3A@36VDC
Output port:	NO(NC)/COM/+/-
Materials:	Zinc alloy plate, stainless steel button
Panel materials:	Stainless steel, wire drawing
Mechanical life time:	500,000 tested
Application:	All kinds of door access control system
Back light color:	Green/Red/ Blue(optional)
OEM:	Welcome OEM, print logo etc
Warranty:	2 years

WHAT IS THE EA-23D'S FEATURE?



1. **Zinc alloy shell** door release button with **LCD backlight**

2. Port: **NO/COM/12V+/12V-**

3. Passed **500000 times** mechanical life test

4. Material: **zinc alloy plate, stainless steel button**

5. Back light color: **Blue, Red ,Green** optional

6. Suitable for all kinds of **door access control system**

7. **2 years warranty** , welcome **OEM**

WHAT DOES THE EA-23D LOOK LIKE?



HOW ABOUT THE EA-23D'S STANDARD PACKAGE?

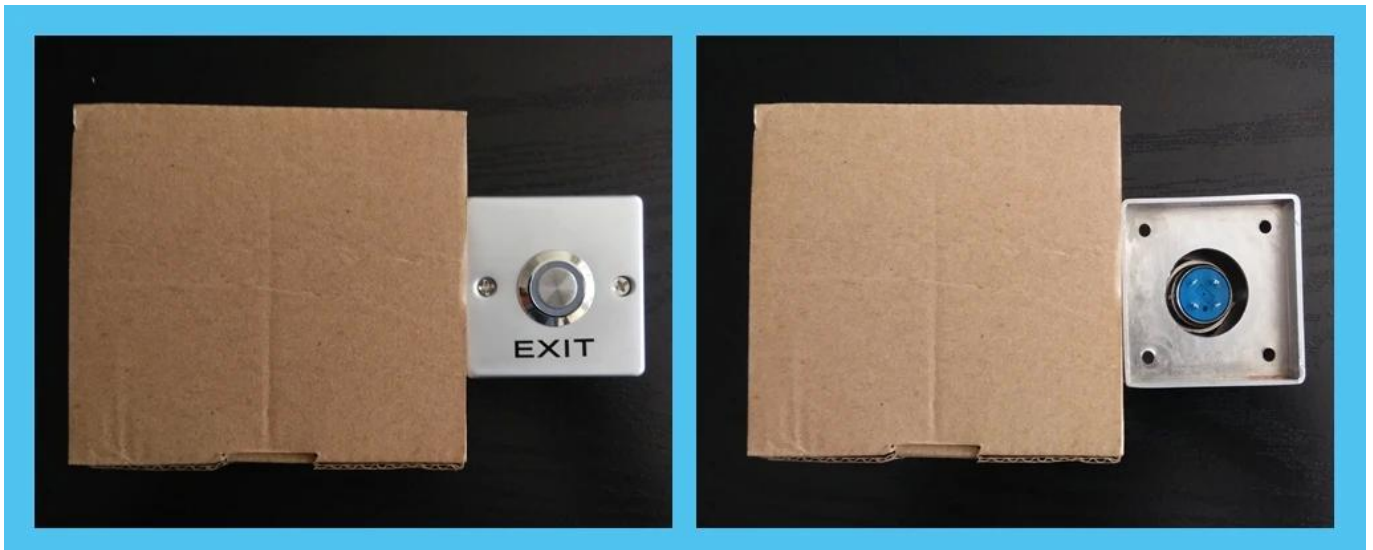

HOW TO USE IT?



Working Schematic diagram:

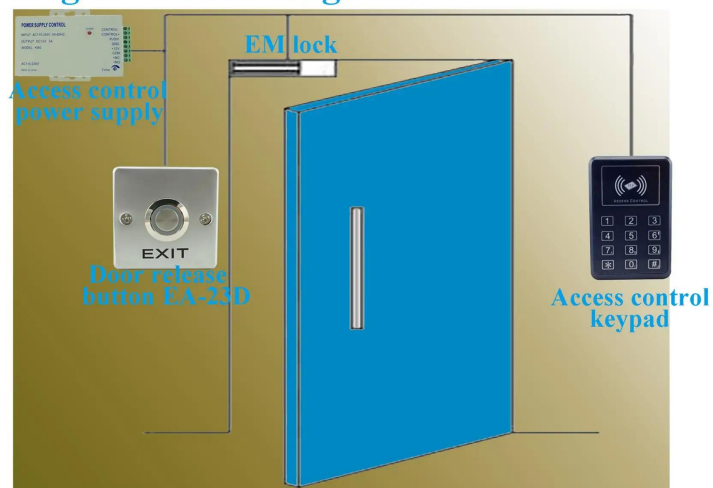

Application place:

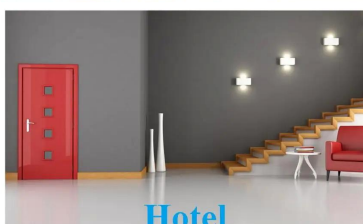
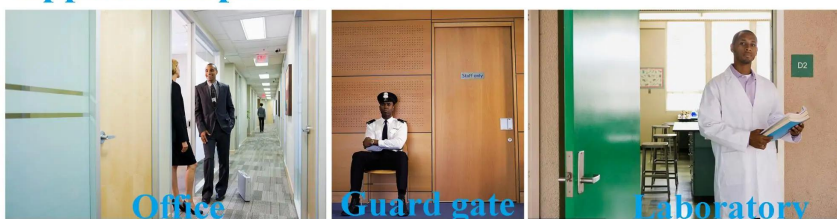

Suitable for all kinds of door access control system!

HOW ABOUT OTHER CHOICE?

SMQT
铭汗科技



SMQT
铭汗科技



SMQT
铭汗科技



SMQT
铭汗科技



SMQT
铭汗科技



SMQT
铭汗科技



SMQT
铭汗科技



SMQT
铭汗科技



SMQT
铭汗科技



OFFICE SHOW



CUSTOMER

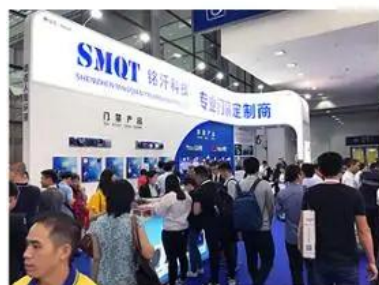

EXHIBITION

2011 Brazil Fair



2012 shen yang Fair



2013 Jinan Fair



2013 Shenzhen Fair



2017 Shenzhen Fair



2012 shen yang Fair



2013 shen yang Fair



2013 Shenzhen Fair



2015 Shenzhen Fair



CERTIFICATION



PACKAGING AND SHIPPING



VARIETY OF PAYMENT OPTIONS

T/T
30/70

L/C
AT SIGHT/90DAY



FAQ

Q: Can I have a sample order?

A: Yes, we are willing to offer trial sample order to you for quality test. Mixed samples are acceptable.

Q: What is the lead time?

A: Sample needs 1-3 working days, mass production time needs 10-15 working days for order less than 5000pcs.

Q: Do you have any MOQ limit?

A: EXW MOQ is 100pcs under blank box.

Q: How do you ship the goods and how long does it take arrive?

A: The sample will be sent to you by optional shipping service (couriers, air, and sea). The delivery time depends on the shipping service.

Q:How will we proceed the order if I have logo to print?

A:Firstly, we will prepare artwork for visual confirmation. If the color and position are right, we would make sampling firstly from silk print factory and take picture for your second confirmation before mass production.