

Square shape wired ABS plastic magnetic contact switch sensor



EB-139B'S MAIN PARAMETER

Product Name:	Square shape wired ABS plastic magnetic contact switch sensor
Model number:	EB-139B
Working voltage:	Max DC 100
Working current:	Max 0.5A
Power consumption:	10W
Interface port:	NC/COM
Induction gap:	20~30mm
Size:	Reed part:106*16*16(mm) Magnet part:106*16*16(mm)
Switch life time:	>100000 times
Feature:	Suitable for fire emergency door
Suitable for:	All kinds of door access control system and burglar alarm system
Material:	ABS housing+Reed switch
Housing color:	Silver

Weight:	2 pairs per bag, per bag weight 130g
Warranty:	2 years warranty
OEM:	Welcome OEM

EB-139B'S FEATURE SHOW

Waterproof



Size

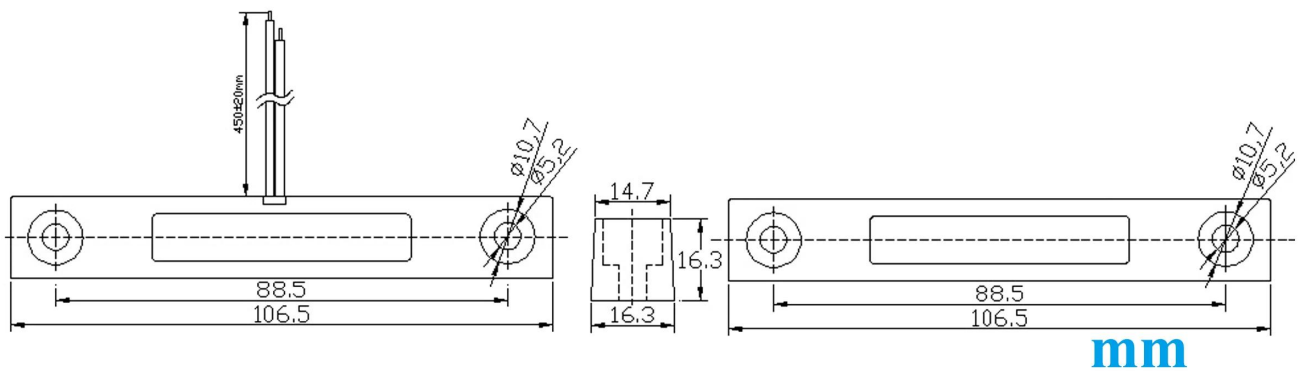

NC mode working principle

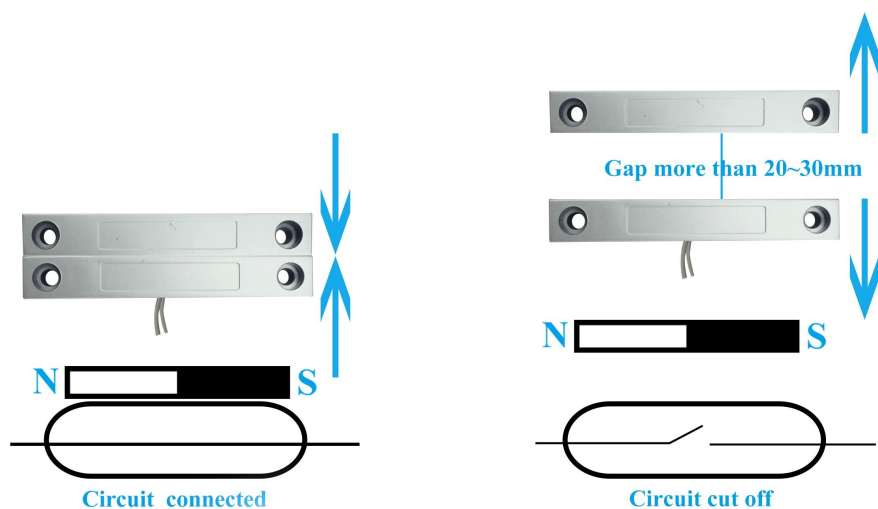

Installation

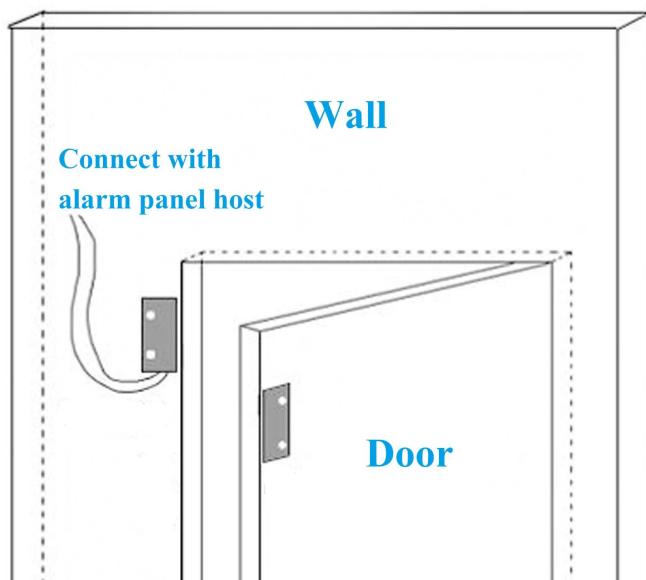

Packaging



HOW ABOUT OTHER CHOICE?

SMQT
铭汗科技



SMQT
铭汗科技



SMQT
铭汗科技



SMQT
铭汗科技



SMQT
铭汗科技



SMQT
铭汗科技



SMQT
铭汗科技



SMQT
铭汗科技



SMQT
铭汗科技

