

PRODUCT THE ARRIVAL OF THE GOODS



<https://eis.en.alibaba.com/>

search

— 114 —

Parameter	
Product name	Wired white vibration sensor alarm price
Model	EB-189
Dimension	26×86×25(mm)
Operating voltage	DC9-16V
Operating current	15mA
Tamper contact	NC,DC12V/max50mA
Alarm contact	NC,DC12V/max50mA
Alarm time	2.2s
Installation height	1.5- 3.5m
Pre-alarm time	1mins
Induction method	acoustic sensors
Operating temperature	-20℃~50℃

What Features of our vibrate sensor?

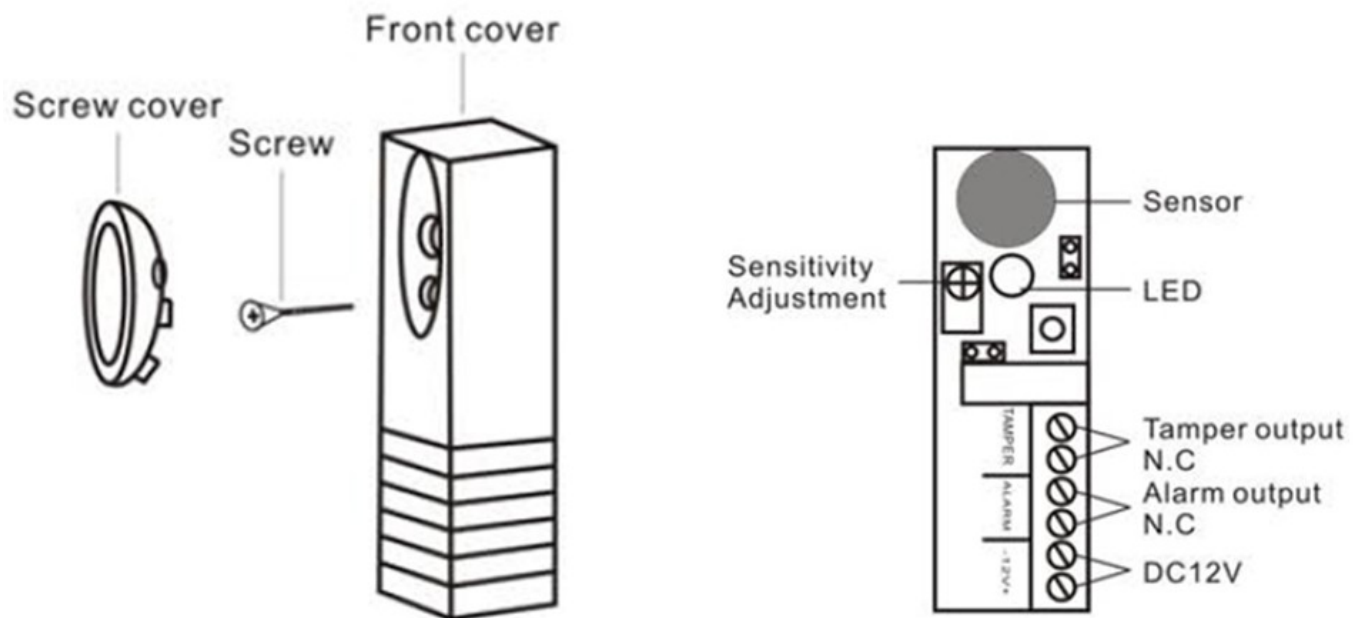

IN-KIND SHOOTING

PRODUCT PICTURE



APPLICATION

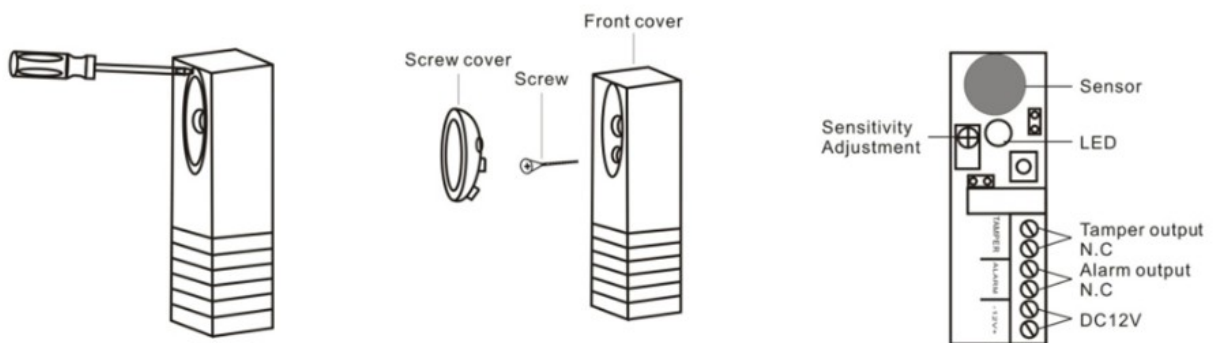

Where to use :

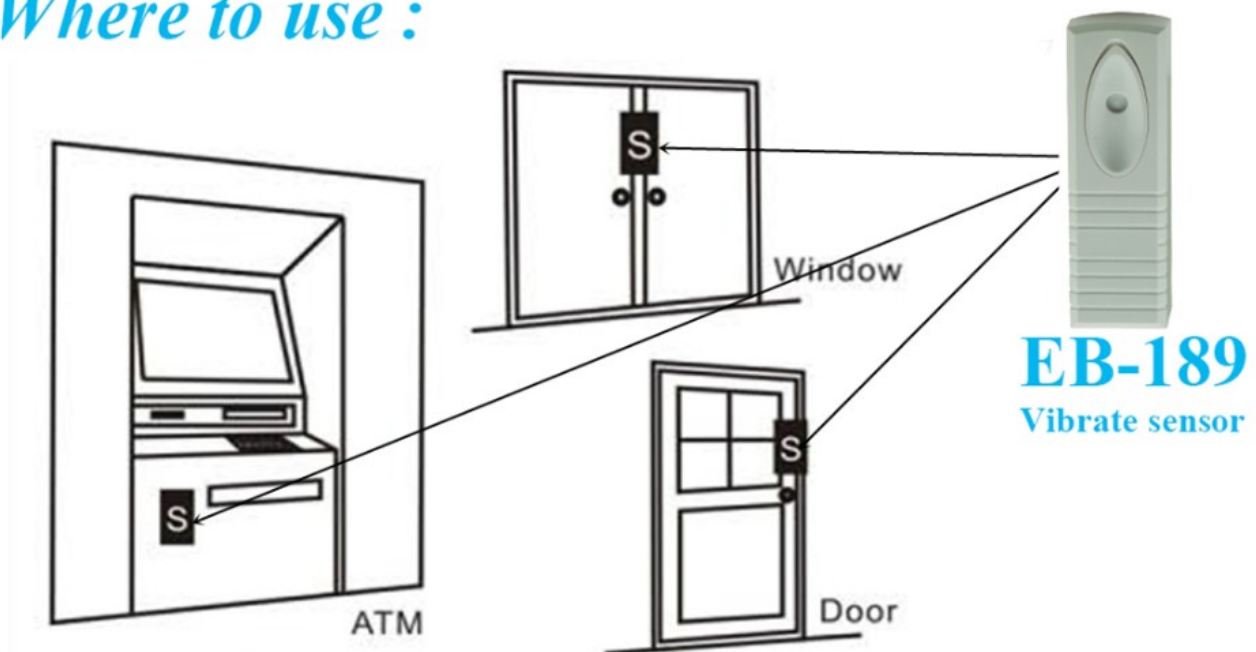

SHOW CASE

SIMILAR PRODUCT

SMQT™



CE RoHS FC

SMQT™



CE RoHS FC

SMQT™



CE RoHS FC

SMQT™



CE RoHS FC

SMQT™



CE RoHS FC

SMQT™



CE RoHS FC

SMQT™



CE RoHS FC

SMQT™



CE RoHS FC

SMQT™



CE RoHS FC

OFFICE SHOW



CUSTOMER



EXHIBITION



CERTIFICATE



HOW TO COOPERATION



Trade terms:	EXW
Payment terms:	T/T, Western union, Paypal etc
Delivery time:	Normal order within 7 days, bulk order 10-15days
Packing:	Neutral paper box and paper carton
Shipping:	Express company or by sea, by air or appointed by buyer

FAQ

Q:Can I have a sample order?

A:Yes, we are willing to offer trial sample order to you for quality test. Mixed samples are acceptable.

Q: What is the lead time?

A:Sample needs 1-3 working days, mass production time needs 10-15 working days for order less than 5000pcs.

Q: Do you have any MOQ limit?

A:EXW MOQ is 100pcs under blank box.

Q: How do you ship the goods and how long does it take arrive?

A: The sample will be sent to you by optional shipping service (courier, sea, air, and sea). The delivery time depends on the shipping service.

Q: How will we proceed the order if I have logo to print?

A: Firstly, we will prepare artwork for visual confirmation. If the color and position are right, we would make sampling firstly from silk print factory and take picture for your second confirmation before mass production.

Q: Does alarm panel work with any sensor?

A: The alarm panel can work with all dry contact wired detectors and wireless detector, including almost all

of the wireless sensors from Chinese manufacturers. The wireless encode and decode is EV1527 or our wireless sensors.