

Fechadura inteligente comercial SMQT ML-311: parafuso de encaixe elétrico embutido de 12V DC para controle de acesso de escritório e porta de vidro



Parâmetro principal do ML-311

Nome do produto:	Fechadura inteligente comercial SMQT ML-311: parafuso de encaixe elétrico embutido de 12V DC para controle de acesso de escritório e porta de vidro
Número do modelo:	ML-311
Tensão operacional:	DC12V
Corrente inicial:	900mA
Corrente operacional:	150mA
Materiais:	Liga de alumínio
Tamanho:	Greve: 200Lx34WX41H (mm) Placa de metal: 90Lx25Lx2A (mm)
Mecanismo de bloqueio:	Bloqueado quando ligado, desbloqueado quando desligado
Peso de uma única fechadura:	0,5kg

Quais recursos o ML-311 possui?

Apperance

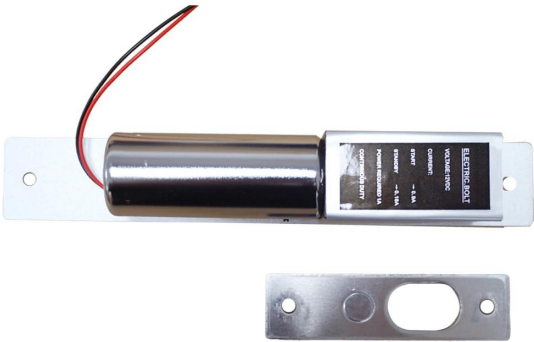

Size

Bolt Lock Body:

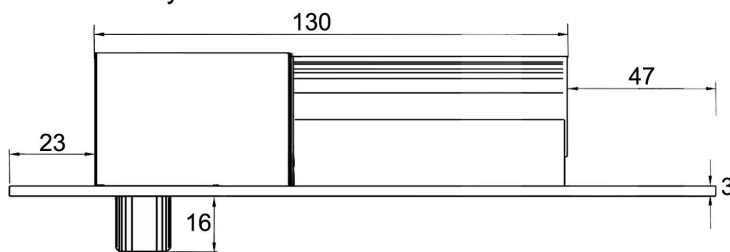

Magnetic Plate:

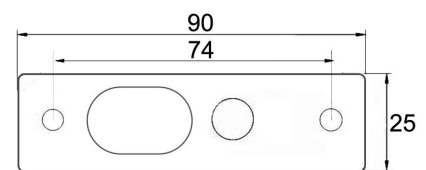
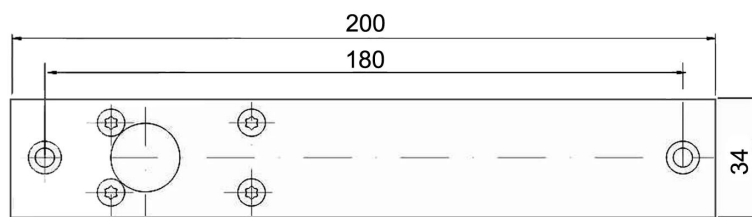

Decorative Plate:

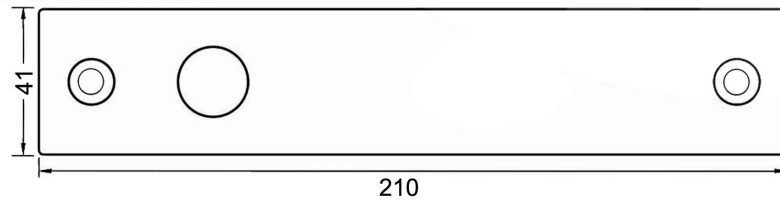

:mm

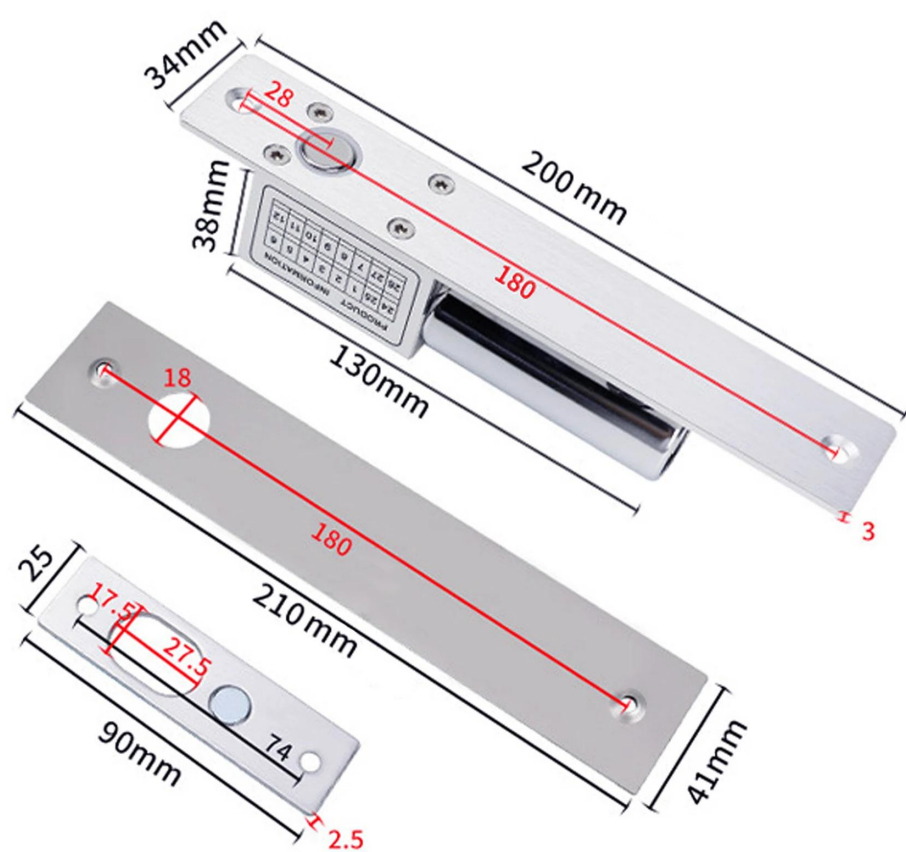

Aluminum alloy material

The lock body is made of high-quality aluminum alloy.



Corrosion-resistant



Antioxidant



More durable

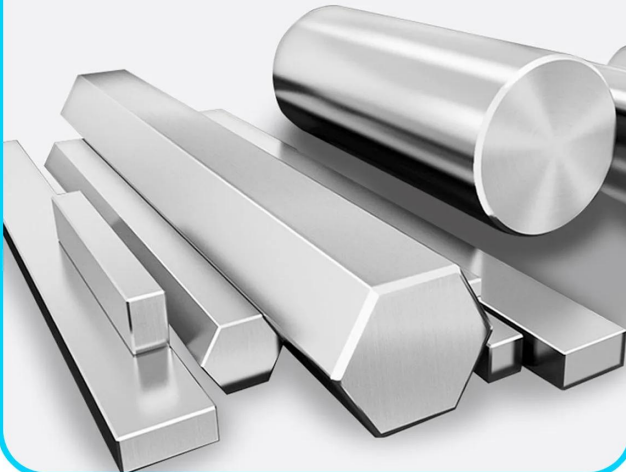

Stainless steel latch

Unlocks upon power loss and locks upon re-electrification



Passed durability tests with over
100,000 lock openings



Pure copper coil

More stable



Packing



Que tal outra escolha?

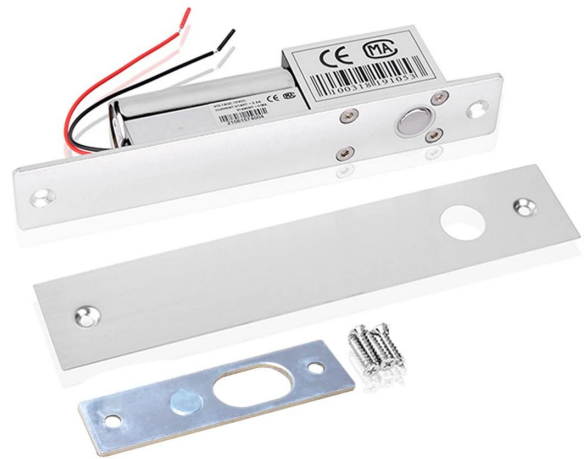

SMQT show



Team



Factory



Certificate



Office

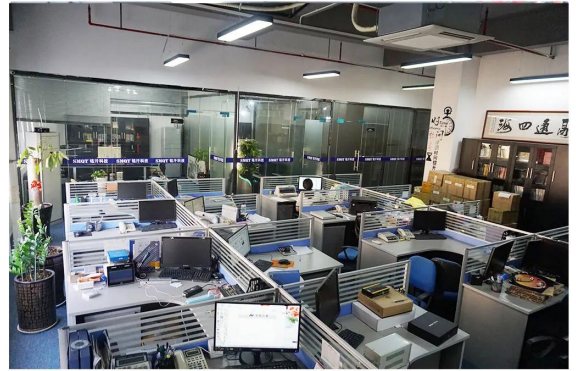

Office



Workshop



Workshop



Workshop



Warehouse

