

Đầu đọc thẻ điều khiển truy cập RFID 125KHz EA- 92DK



OLED display
White/Black color optional
Accept Logo print

Main parameter

| | |
|-------------------|-----------------------------|
| Model NO. | EA-92DK |
| Power supply | DC 9-15V |
| Power consumption | <1W |
| Card type | 125 KHz |
| Read range | 5-10 cm |
| Cable distance | 150m |
| Output Format | WG26/WG34(optional) |
| Keypad output | 4bits/8bits(optional) |
| LED Tips | Flash card /Doorbell/Keypad |
| Clock | Yes |
| Reading tips | Beeper/LED/ OLED Display |
| Dimensions | 95L×95W×21H(mm) |
| Weight(g) | 120 ± 10 |
| Material | PC+ABS Screen cover:PMMA |
| Environment | -30℃to+65℃ |

Size

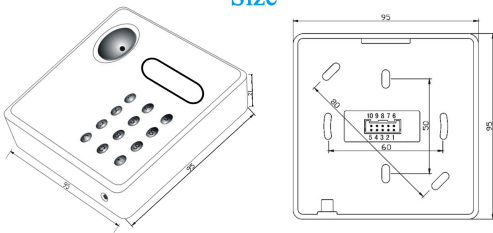

Wire port introduction

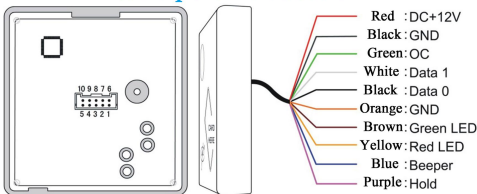

| NO | Color | Function | Description |
|----|--------|------------|--|
| 1 | Red | 12V+ | DC Power 12V |
| 2 | Black | GND | DC Power 0V |
| 3 | Green | OC OUT** | OC Out to output doorbell signal or anti-tamper signal |
| 4 | White | DATA1 | Wiegand DATA1 Output |
| 5 | Black | DATA0 | Wiegand DATA0 Output |
| 6 | Orange | GND | Signal Grounding |
| 7 | Brown | Green LED* | Grounding to display 1" message and green LED lights up |
| 8 | Yellow | Red LED* | Grounding to display 2" message and red LED lights up |
| 9 | Blue | Beeper | Beeper controller, grounding to work |
| 10 | Purple | Hold | Card reading controller, grounding to stop therefore reading |

Wire diagram

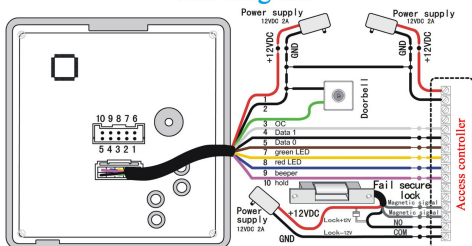

2 years warranty

